

3. EXPLAIN HUMAN DEVELOPMENT  
THROUGH FOSSILS

4. ANALYZE/EXPLAIN  
BIOL. DIVERSITY

PHYSICS

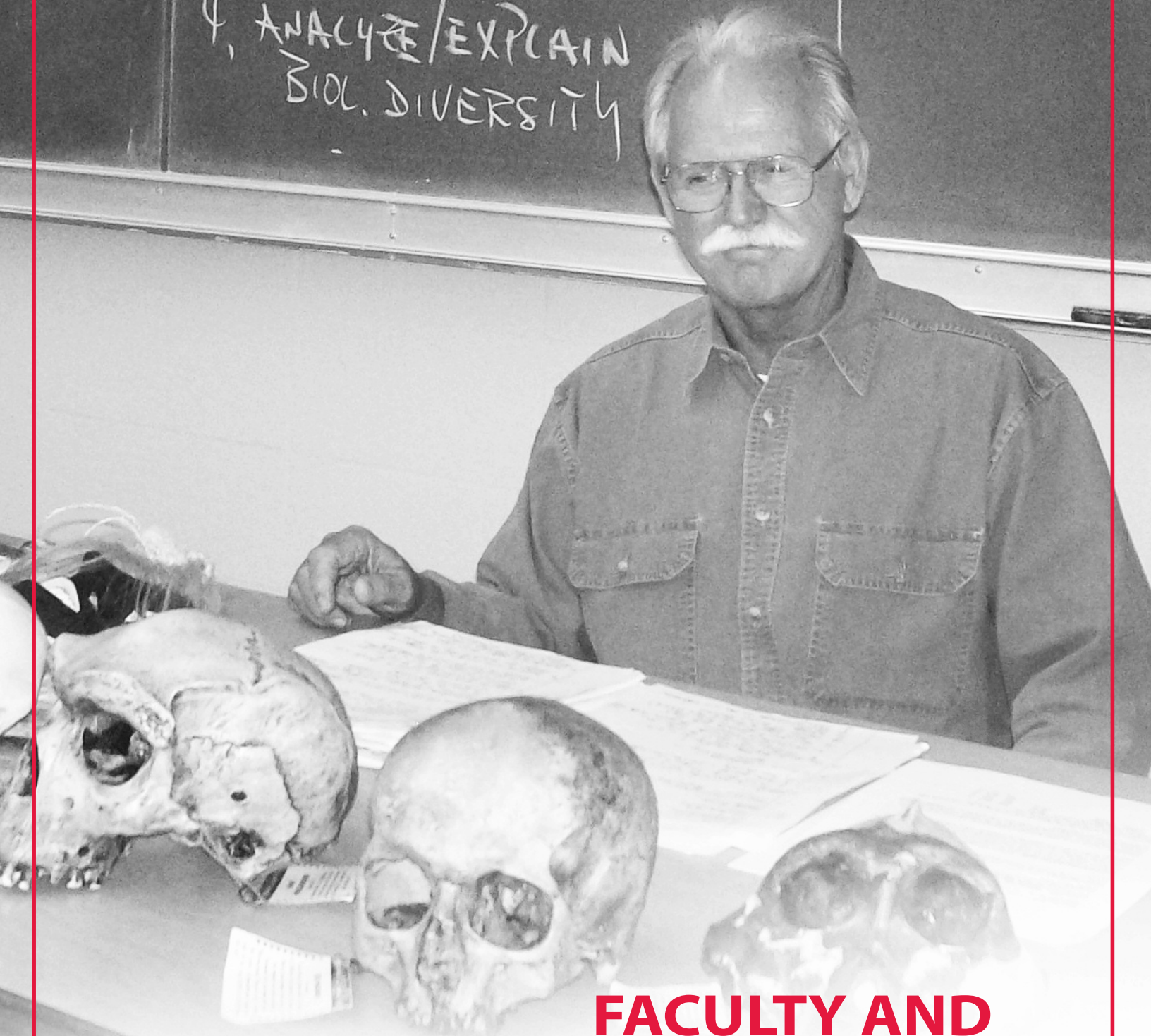

**FACULTY AND  
ADMINISTRATION**

## Administration

### **AGUIRRE, JUSTINA**

*Dean of Health and Public Safety*

M.S.N., Clarkson College  
B.S.N., California State University, Dominguez Hills  
A.S., Imperial Valley College

### **AKINKUOYE, NICHOLAS O.**

*Vice President for Academic Services*

Ed.D., Virginia Polytechnic Institute and State University  
M.S., Texas Southern University  
B.S., Elizabeth City State University

### **CEASAR, TED**

*Dean of Counseling*

M.S.W., San Diego State University  
B.A., University of Michigan

### **JAIME, VICTOR**

*Superintendent/President, Professor*

Ed. D., Northern Arizona University  
Ed. S., Point Loma Nazarene College  
M.S., San Diego State University  
B.A., University of California, Irvine

### **LARRY, SHAWN**

*Chief Human Resource Officer*

J.D., University of The Pacific-Mc George School of Law  
B.A., University of California Santa Barbara

### **LAU, JOHN**

*Vice President for Administrative Services*

B.S., San Diego State University

### **LOPEZ, SERGIO A.**

*Dean of Student Affairs and Enrollment Services*

*Interim Vice President for Student Services*

M.Ed., University of San Diego  
B.A., San Diego State University  
A.A., Imperial Valley College

### **NAIMPALLY, ASHOK**

*Dean of Math & Sciences*

Ph.D., Syracuse University  
B. Tech., Indian Institute of Technology, Bombay

### **SILVA, EFRAIN**

*Dean of Economic and Workforce Development*

M.B.A., Northern Arizona University  
B.A., San Diego State University  
A.A., Imperial Valley College

### **ZIELINSKI, DAVID**

*Dean of Arts, Letters and Learning Services, Professor*

M.A., San Diego State University  
A.B., San Diego State University

## The Faculty

### **ALVARADO, BEATRIZ**

*Counselor, Professor*

M.A., University of San Diego  
B.A., San Diego State University  
A.A., Imperial Valley College

### **ARGÜELLES, TRINIDAD**

*Counseling Chair, Professor*

M.A., University of Redlands  
B.A., San Diego State University  
A.A., Imperial Valley College

### **ARMENTA, CELESTE**

*Professor, Nursing*

F.N.P., University of San Diego  
M.S., National University  
B.S., National University

### **ARTECHI, G. OLGA**

*Counselor, EOPS/CARE Coordinator, Professor*

M.A., San Diego State University  
B.A., San Diego State University

### **AVILA, BEATRIZ**

*Counselor, Professor*

M.A., University of Redlands  
B.S., California Polytechnic State University, San Luis Obispo

### **BAILEY, GORDON**

*Assistant Professor, CIS/CISCO Networking*

M.A., Southern Oregon University  
B.A., University of Alaska  
A.S., University of Alaska

### **BAUKHOLT, ROBERT**

*Professor, English*

M.A., California State University, Northridge  
B.A., University of California, Los Angeles  
A.A., College of the Canyons

### **BECKLEY, JEFFREY**

*Professor, Business*

J.D., University of Washington  
B.A., Idaho State University

### **BEMIS, ROBERTA**

*Professor, English*

M.A., Northern Arizona University  
B.A., San Diego State University

### **BENEDICTO, ALTO**

*Assistant Professor, Chemistry*

Ph.D., California Institute of Technology  
M.A., Claremont Graduate University  
B.S., University of the Philippines

### **BENNETT, CAROLINE**

*Associate Professor, Mathematics*

M.A., San Diego State University  
B.A., San Diego State University

### **BLEK, CRAIG**

*Professor, Economics*

M.A., University of Delaware  
B.A., University of California, Los Angeles

### **BROCK, ALISON**

*Assistant Professor, Office Technologies*

M.S., San Diego State University  
B.S., William Woods University

### **BURT, JEFFERY**

*Assistant Professor, Mathematics*

M.A., San Diego State University  
B.A., San Diego State University  
A.S., Imperial Valley College

### **CAMPOS, GILBERT**

*Counselor, Professor*

M.A., University of Redlands  
B.A., San Diego State University

### **CAÑEZ - SAVALA, SAID**

*Counselor, Professor*

M.Ed., University of San Diego  
B.A., San Diego State University

### **CASTRAPEL, RICK**

*Professor, Computer Science/ Mathematics*

M.A., Claremont Graduate University  
B.A., Portland State University

### **CASTRO, GUADALUPE**

*Clinical Mental Health Counselor, Assistant Professor*

NFT/M.S.C., University of Phoenix  
B.A., San Diego State University  
A.A., Imperial Valley College

### **CHANG, EDDIE**

*Associate Professor, Biology*

Ph.D., University of Missouri  
M.A., San Francisco State University  
B.S., University of San Francisco

**CHIEN, ANDREW***Professor, Biology*

Ph.D., University of Illinois  
 M.S., Oklahoma State University  
 M.B.A., California State University, Los Angeles  
 B.S., Southeast Missouri State University

**COLIO, PEDRO***Assistant Professor, Nursing*

M.S., University of San Diego  
 B.S., San Diego State University  
 A.A., Imperial Valley College

**CORMIER, JUDY***Professor, English*

M.A., California State University, Long Beach  
 B.A., California State University, Long Beach  
 A.A., Golden West College

**COZZANI, ALEJANDRO***Associate Professor, Physics/Mathematics*

Ph.D., American World University  
 M.S., American World University  
 M.A., San Diego State University  
 M.S., Chadwick University  
 B.S., Instituto Nacional Superior del Profesorado "Dr. Joaquin V Gonzalez"

**CRAVEN, JULIE***Professor, English as a Second Language*

M.A., United States International University  
 B.A., San Diego State University  
 A.A., Fullerton College

**DAVID, SAMUEL***Professor, Chemistry/Biology*

Ph.D., Biochemistry (India)  
 M.Sc., Biochemistry (India)

**DAVIS, HOPE***Professor, Music*

Ph.D., University of Southern Mississippi  
 D.M.A., Louisiana State University  
 M.A., University of Wyoming  
 B.M., Royal College of Music/Trinity College  
 A.M., Trinity College

**DEYO, JEFF***Professor, Exercise Science, Wellness & Sports*

M.S., West Virginia University  
 B.A., Mount Marty College

**DIAZ, DOLORES***Student Support Services**Project Director, Professor*

M.Ed., University of San Diego  
 B.A., San Diego State University

**DORANTES, KATHLEEN***Professor, English*

M.S., Columbia University, New York  
 M.A., California State University, Fullerton  
 B.A., McGill University, Montreal

**DORSEY, TANYA***Counselor, Professor*

M.A., University of Redlands  
 B.A., San Diego State University  
 A.A., Imperial Valley College

**DRURY, DAVE***Professor, Exercise Science, Wellness & Sports*

M.S., Brigham Young University  
 B.S., University of La Verne

**DUVA, MARK***Assistant Professor, Psychology*

Ph.D., University of California, Riverside  
 M.A., University of California, Riverside  
 B.A., California State Polytechnic University, Pomona

**EDWARDS, AARON***Associate Professor, Philosophy*

M.A., San Diego State University  
 B.A., San Diego State University  
 A.A., San Diego Mesa Community College

**ESQUEDA, JESUS***Counselor, Professor*

M.A., United States International University  
 B.A., San Diego State University

**ESQUER, MARIA***Professor, Calworks Counseling Coordinator*

M.A., Point Loma Nazarene University  
 B.A., San Diego State University  
 A.A., Imperial Valley College

**FELIX, MIREYA***Counselor, Professor*

M.S., National University  
 B.S., San Diego State University  
 A.A., Imperial Valley College

**FINNELL, GAYLLA***Distance Education Coordinator, Professor*

M.P.A., San Diego State University  
 B.S., San Diego State University  
 A.A., A.S., Imperial Valley College

**FISHER, JAMES***Professor, Chemistry*

Ph.D. University of Idaho  
 B.A., University of Montana

**FITZSIMMONS, RICHARD***Professor, Nursing*

F.N.P., Clarkson College  
 M.S.N., Madonna University  
 B.S.N., Madonna University

**FLETES, MYRIAM***Educational Talent Search Project Director,**Professor*

M.A., University of Redlands  
 B.A., University of Arizona

**FRISTRUP, CAREY***Counselor, Professor*

M.A., Point Loma Nazarene University  
 B.A., San Diego State University

**GARCIA, MARTHA***Professor, Special Projects Coordinator*

Ed.D., San Diego State University  
 M.S., National University  
 B.S., San Diego State University  
 A.A., Imperial Valley College

**GARCIA, OLIVIA***Associate Professor, English*

M.A., National University  
 B.A., San Diego State University

**GARCIA, RAQUEL***Instructional Specialist, Professor*

M.A., United States International University  
 B.A., San Diego State University

**GARZA, ALEJANDRO***Professor, English as a Second Language*

M.A., California State Polytechnic University, Pomona  
 B.A., California State University, Los Angeles  
 A.A., Pasadena City College

**GHANIM, WALID***Professor, Computer Information Systems*

M.A., California State University, Dominguez Hills  
 B.S., California State University, Dominguez Hills

**GILISON, DANIEL***Professor, Biology*

Ph.D., Stanford University  
 B.A., Johns Hopkins University

**GOLDSBERRY, RICK***EMS Program Director/Coordinator/**Associate Professor*

A.A., Imperial Valley College

**GRETZ, SUZANNE***Professor, History*

M.A. California State University, Fullerton  
 B.A. University of California, Santa Barbara

**HANSINK, TODD***Professor, Business*

M.P.A., Brigham Young University  
 B.S., Brigham Young University

**HARRIS, DIANE***Professor, English as a Second Language*

M.A., California State University, Fresno  
 B.A., California State University, Fresno

**HEGARTY, CAROL***Professor, Art*

M.F.A., School of the Art Institute of Chicago  
 B.F.A., School of the Art Institute of Chicago

**HERNANDEZ, OSCAR***Associate Professor, Mathematics*

B.S., San Diego State University

**HEUMANN, MICHAEL***Professor, English*

Ph.D., University of California, Riverside  
 M.A., University of California, Riverside  
 B.A., University of California, Riverside

**HOLT, STEVE***Professor, Emergency Medical**Technologies*

A.S., Imperial Valley College

**HOPPE, FRANK***Reference Librarian, Associate Professor*

M.L.I.S., University of California, Los Angeles  
 B.A., Antioch University

**HORTON, SIDNEE***Professor, Exercise Science, Wellness & Sports*

M.S., California State Polytechnic University, Pomona  
 M.A., California State University, Sacramento  
 B.A., California State University, Long Beach

**HOWELL, KEVIN***Associate Professor, English*

M.S., Suny Cortland  
 M.A., Suny Binghamton  
 B.A., Temple University



**HU, ZHONG***Math Lab Tutorial Specialist*

M.A., University of California, Los Angeles  
 B.A., University of California, Los Angeles

**JEPSON, ROSALBA***Associate Professor, Nursing*

M.S., University of Phoenix  
 B.S., University of Phoenix  
 A.S., Imperial Valley College

**KELLY, NANNETTE***Professor, Art and Humanities*

Ph.D., The Union Institute  
 M.A., Southern California School of Theology,  
 Claremont  
 B.A., California State University, Fullerton

**KITZMILLER, JILL***Associate Professor, Mathematics*

M.A., San Diego State University  
 B.A., University of California, San Diego

**KNAAK, MANFRED***Professor, Anthropology*

M.A., San Diego State University  
 B.A., San Diego State College

**LAVERY, RUSSELL***Professor, Astronomy/Physical Science*

Ph.D., University of Hawaii, Manoa  
 M.A., University of Hawaii, Manoa  
 B.S., University of Massachusetts

**LAY, NANCY***Professor, Reading*

M.A., San Diego State University  
 B.A., San Diego State University  
 A.A., Imperial Valley College

**LEHTONEN, ERIC***Professor, Mathematics*

M.A., San Diego State University  
 B.A., San Diego State University

**LEON, ALLYN***Professor, Mathematics*

M.S., Texas A&M University  
 B.A., University of California, San Diego

**LOFGREN, MARY***Counselor, Professor*

M.A., University of Redlands  
 B.A., University of Redlands

**LOPEZ, JOSE***Professor, Automotive Technology*

A.S., Imperial Valley College  
 Cert. Auto Tech., Los Angeles  
 Trade Technology College  
 Automotive Master Technician Certification  
 Automotive Factory Training Certification  
 B.S., Long Beach State University

**LOPEZ, ROSALIE***Upward Bound Project Director,  
Professor*

M.Ed., University of San Diego  
 B.A., San Diego State University

**LOVITT, PAIGE***High Tech Center Specialist, Professor*

M.S., California State University, Fresno  
 B.A., California State University, Fresno

**MADANI, BEHRANG***Assistant Professor, Chemistry*

Ph.D., Louis Pasteur University  
 M.S., Louis Pasteur University  
 B.S., Azad University

**MARQUEZ, RALPH***Counselor, Professor*

M.Ed., University of San Diego  
 B.A., University of California, San Diego

**MARTINEZ, ANDRES***Professor, Computer Information Systems*

M.S., National University  
 B.A., San Diego State University  
 A.S., Imperial Valley College

**MARTY, KEVIN***Professor, Geology*

M.S., University of New Orleans  
 B.S., Central Washington University

**MAZEROLL, LORRAINNE***Counselor, Professor*

M.A., University of Redlands  
 B.A., San Francisco State University

**MECATE II, JAMES***Professor, Exercise Science, Wellness & Sports*

M.S., Brigham Young University  
 B.S., Brigham Young University

**MENDOZA, LIISA***Associate Professor, American Sign Language*

B.S., University of Arizona

**MERCADO, MARIA LOURDES***Counselor, Professor*

M.A., Point Loma Nazarene University  
 B.A., San Diego State University  
 A.A., Imperial Valley College

**MILLER, FONDA***Professor, Child, Family, and Consumer Sciences*

M.S., Iowa State University  
 B.A., Otterbein College

**MIRANDA, FRANK***Professor, Air Conditioning &  
Heat Ventilation*

Contractors State License

**MORA, CRISTAL***Assistant Professor, Nursing*

M.S., University of Phoenix  
 B.S., University of Phoenix

**MORRELL, THOMAS***Professor, Biology*

Ph.D., Pennsylvania State University  
 M.S., University of Nevada  
 B.S., University of Montana  
 A.A., Columbia Community College

**MORRIS, AUDREY***Assistant Professor, Reading*

M.S., Buffalo State University  
 M.S., University of Oklahoma  
 B.A., Mercer University

**MOSS, SUSAN***Associate Professor, Biology*

M.S., University of Florida  
 M.S., University of Oklahoma  
 B.A., Mercer University

**NAVA, NORMA***DSP&S Coordinator, Professor*

M.S., San Diego State University  
 B.S., San Jose State University

**SANDOVAL, LILIA***Calworks Assessment Coordinator, Professor*

M.A., Point Loma Nazarene University  
 B.S., San Diego State University  
 A.S., Imperial Valley College

**NELIPOVICH, JILL***Associate Professor, Mathematics*

M.A., San Diego State University  
 B.A., San Diego State University

**NORRIS, TERRY***R/W Lab Tutorial Specialist, Professor*

M.D., Northwest Baptist Seminary  
 B.A., The Master's College

**NUÑEZ, NORMA***Student Success and Support Coordinator,  
Professor*

M.S., San Diego State University  
 A.B., San Diego State University  
 A.A. Imperial Valley College

**ORFANOS-WOO, STELLA***Counselor, Professor*

M.A., Point Loma Nazarene College  
 B.A., University of California, Riverside

**ORTIZ, DANIEL JR.***Assistant Professor, Nursing*

MSN., Grand Canyon University  
 BSN., University of Phoenix  
 ADN., Imperial Valley College

**PAGE, BRUCE***Professor, Speech/Journalism*

M.A., American University  
 B.A., University of British Columbia  
 A.A., Skagit Valley College

**PASTRANA, LETICIA***Professor, English as a Second Language*

M.A., Monterey Institute of International Studies  
 B.A., University of California, Riverside

**PATTERSON, JAMES***Professor, English*

Ph.D., The Union Institute  
 M.A., Arizona State University  
 B.A., Grand Canyon University

**PAULEY, PATRICK***Professor, Agriculture*

Ed.D., Texas Tech University  
 M.S., California State Polytechnic University  
 B.S., California State Polytechnic University  
 A.S., West Hills Community College

**PLASCENCIA, JOSE**

*Counselor, Professor*  
 M.S.W., San Diego State University  
 B.A., San Diego State University  
 A.A., Imperial Valley College  
 A.S., Imperial Valley College

**PONCE, JOSEFINA**

*Professor, English as a Second Language*  
 M.A., Northern Arizona University  
 B.A., San Diego State University  
 A.A., Imperial Valley College

**PRADIS, RICARDO**

*Professor, Automotive Technology*  
 Universal Technical Institute, Phoenix AZ

**RANGEL, JAVIER**

*Associate Professor, Spanish*  
 Ph.D., University of California, Los Angeles  
 M.A., California State University, San Diego  
 A.B., California State University, San Diego  
 A.A., Imperial Valley College

**RAPP, FRANK**

*Professor, English*  
 M.A., San Diego State University  
 B.A., San Diego State University

**RICE, SYDNEY**

*Associate Professor, English as a Second Language*  
 M.A., California State University, Long Beach  
 B.A., Whitworth College

**ROBINSON, ANDREW**

*Assistant Professor, Exercise Science, Wellness, Sports & Men's Basketball Coach*  
 M.P.H., California State University, Fresno  
 B.A., California State University, Fresno

**RODILES, NICOLE**

*Assistant Professor, Psychology*  
 M.A., San Diego State University  
 B.A., San Diego State University

**RODRIGUEZ, KATHY**

*Assistant Professor, Administration of Justice*  
 M.S., National University, San Diego  
 B.S., San Diego State University

**ROMERO, YOLANDA**

*Counselor, Professor*  
 M.A., United States International University  
 B.A., San Diego State University  
 A.A., Imperial Valley College

**ROWLEY, DEIRDRE**

*Professor, English*  
 M.A., Northeastern University  
 B. A., University of New Hampshire

**RUIZ, ANGELICA**

*Professor, Business*  
 M.A., California State University, San Bernardino  
 B.A., Loma Linda University  
 A.A., Imperial Valley College

**RUIZ, JOSE**

*Professor, Spanish*  
 Ph.D., University of California, San Diego  
 M.A., San Diego State University  
 B.A., San Diego State University

**SANCHEZ-DOMINGUEZ, ROMANO**

*Professor, Spanish*  
 M.A., University of California, San Diego  
 B.A., University of California, San Diego

**SCHEUERELL, EDWARD**

*Professor, English as a Second Language*  
 M.A., University of Illinois  
 M.A., (Spanish) University of Illinois  
 B.A., University of Illinois

**SHANER, CHRISTINA**

*Professor, English*  
 M.A., Carnegie Mellon University  
 B.A., Texas Christian University

**SHEPPARD, DAVID**

*Professor, Child, Family, and Consumer Sciences*  
 M.S., San Diego State University  
 B.S., Cal State University Fullerton

**SHIPMAN, KRISTEN**

*Counselor, Assistant Professor*  
 M.A., University of Redlands  
 B.S., California State Polytechnic University, San Luis Obispo

**SHOKOUFI, MARDJAN**

*Professor, Mathematics*  
 M.S., San Diego State University  
 B.S., California State University, Northridge

**SIGALA, ANA**

*Counselor, Professor*  
 M.A., Point Loma Nazarene University  
 B.A., San Diego State University

**SIMPSON, SCOTT**

*Professor, English*  
 M.A., University of Illinois  
 M.A., Michigan State University  
 B.A., University of Maine

**SOLOMON, LISA**

*Professor, History*  
 M.A., California State University, Stanislaus  
 B.A., California State University, Fresno

**SOTO, VERONICA**

*Transfer, Articulations and University Partnerships Coordinator, Assistant Professor*  
 M.A., University of Redlands  
 B.A., San Diego State University  
 A.S., Imperial Valley College

**STATON, M. ROBIN**

*Professor, Psychology*  
 M.A., West Virginia University  
 B.A., University of Charleston

**SULLIVAN, TERRIE**

*Assistant Professor, Nursing*  
 B.S., California State University, Dominguez Hills  
 M.S., University of Phoenix  
 A.S., Imperial Valley College

**SUN, JIA**

*Assistant Professor, Biology*  
 Ph.D., University of California, Riverside  
 M.S., California State University, Long Beach  
 B.S., University of California, Los Angeles

**SWIADON, GLENN**

*Associate Professor, French*  
 Ph.D., Universidad Nacional Autonoma de Mexico  
 M.A., University of California, Berkeley  
 B.A., University of California, Berkeley

**THELEN, AUSTEN**

*Assistant Professor, Geography*  
 M.A., University of Kansas  
 B.S., Michigan State University

**TIRADO, XOCHITL**

*Assistant Professor, Reading*  
 M.A., National University  
 M.S., San Diego State University  
 B.A., San Diego State University  
 A.A., Imperial Valley College

**TUCKER, JILL**

*Professor, Exercise Science, Wellness & Sports*  
 M.A., Grand Canyon University  
 B.A., Eastern New Mexico University

**VELASQUEZ, JOSE**

*Professor, Construction Technologies*  
 B.A., San Diego State University  
 A.S., Imperial Valley College

**VOLDMAN, ALEKSANDR**

*Professor, Mathematics*  
 Ed.D, Kishinev Math Institute  
 M.S., San Bernardino University  
 B.S., Northeastern University

**WAINWRIGHT, MARY JO**

*Professor, History*  
 M.A., California State University, Hayward  
 B.A., University of California, Berkeley  
 A.A., Chabot College

**WEBSTER, ROBERTA**

*Assistant Professor, Nursing*  
 M.S., University of San Diego  
 B.S., University of San Diego

**WELLS, EDWARD**

*Administration of Justice Associate Professor/ P.O.S.T. Coordinator*  
 M.P.A., National University  
 B.A., Marquette University

**WHITE, KEVIN**

*Professor, Political Science*  
 M.A., San Diego State University  
 B.A., San Diego State University

**WORSHAM, SABRINA**

*Assistant Professor, Speech*  
 M.A., California State University, Long Beach  
 B.S., Bradley University

**WRIGHT, BRADFORD**

*Associate Professor, History*  
 Ph.D., Purdue University  
 M.A., Purdue University  
 B.A., University of Vermont

**ZAZUETA, CATHY**

*Assistant Librarian, Professor*  
 M.L.S., University of British Columbia  
 B.A., American College in Paris

## Emeritus Faculty

<b>AKERS, H. RUSSELL</b> Physically Limited 1973-1987	<b>BRUNGARDT, MARTHA †</b> Nursing 1972-1985	<b>FINLEY, LUTHER †</b> Engineering 1960-1981	<b>HANN, RICHARD</b> Humanities 1967-2003	<b>LARSSON, HAROLD</b> Astronomy 1966-1984
<b>ALBERDA, STANLEY</b> Dean of Learning Services 1969-1993	<b>BUCKEL, EILEEN</b> Dean of Learning Services 1993-2005	<b>FINNEY, DEE</b> Physical Education 1967-1981	<b>HEBERT, ROGER</b> Physical Education 1968-1994	<b>LEE, CAROL</b> Counselor, Professor 1996-2012
<b>ANDERSON, LESLIE</b> Law Enforcement 1967-1983	<b>CARLSON, MARYLYNN †</b> Nursing 1984-2009	<b>FISCHER, FRED †</b> English 1982-2009	<b>HIGGINS, S. BRENDA</b> Allied Health 2002-2012	<b>LEGARRA, STANLEY</b> Health Education/ Physical Education 1974-1992
<b>ARAGON, RAUL †</b> Counselor, Professor 1973-2006	<b>CARNES, DENNIS †</b> Biology 1995-2009	<b>FUESLER, JACK †</b> Music 1964-1989	<b>HIGGINSON, JANE</b> Environmental Science 2005-2012	<b>LEONARD, THOMAS †</b> Psychology 1964-1972
<b>ARCHULETA, JOE</b> Math 1974-2008	<b>CERDA, DANIEL</b> English 1974-2003	<b>GAGE-MOSHER, RONALD</b> Psychology 2000-2010	<b>HILLHOUSE, ROSANNE</b> English 1963-1999	<b>LEPTICH, DEAN †</b> Speech 1965-1996
<b>BACON, JEANNE</b> Physically Limited 1973-1985	<b>CERDA, ERNESTINE</b> English 1974-2003	<b>GALAMGAM, ADELE †</b> Assistant Librarian 1965-1994	<b>HINSHAW, JOHN †</b> Mathematics 1942-1973	<b>LEWIS, STANLEY H.</b> Ag/Heavy Equip. Mech. 1969-1983
<b>BANKS, STANLEY †</b> Sociology 1966-1987	<b>CHAMPAGNE, PHILIP</b> Welding 1971-1989	<b>GARTIN, HERBERT †</b> Psychology 1966-1978	<b>HUGHES, MERRLYNN</b> Nursing 1986-1997	<b>LOPEZ, HECTOR</b> VP/Stu Svcs/Deputy Supt 1970-1999
<b>BARKALOW, N.C. †</b> Law Enforcement 1974-1981	<b>DAVIS, DONNA</b> Nursing 2001-2015	<b>GENTRY, GLENN A. †</b> Work Experience 1967-1981	<b>JACOBSON, ERIC</b> HISTORY 1992-2015	<b>LOPEZ, REUBEN O.</b> Dean of Extended Campus 1974-2001
<b>BARKER, MICHAEL †</b> Anthropology 1968-1979	<b>DECKER, VAN</b> Music 2000-2015	<b>GERARD, ROBERT †</b> Coord., Special Populations 1988-1993	<b>JACKLICH, JOEL</b> Music 1989-2006	<b>LOWE, JUANITA †</b> Art 1961-1990
<b>BEOPE, FRANCES</b> Counselor, Professor 1975-2012	<b>DePAOLI, JOHN A. †</b> Superintendent/President 1965-1995	<b>GILBERTSON, THOMAS</b> Art 2000-2012	<b>JERGE, MICHAEL †</b> Business, Economics 1967-1999	<b>LUOMA, CRAIG</b> NURSING 1985-2015
<b>BERNARD, WILLIS C.</b> Art 1969-1988	<b>DOMINGUEZ, GILBERT</b> Superintendent/President 1996-2002	<b>GRANADOS, ESTHER</b> Business 1990-1999	<b>JONES, SHIRLEY</b> Counseling 1982-1999	<b>MACCI, BARBARA</b> Dean of Voc Ed 1976-1996
<b>BILEY, PATTI</b> English 1990-2011	<b>DUFF, JACK</b> Counseling 1981-1985	<b>GREVATT, JAMES</b> Counseling 1975-1996	<b>KELSOE, LEON</b> History & Exercise Science 1970-2003	<b>MAGNO, JANIS</b> Dean of Enrollment Services 1983-2012
<b>BILLINGS, LANELLE</b> Business 1974-1999	<b>FARRAR, LLOYD †</b> History 1968-1992	<b>GRIFFIN, WILLIAM †</b> Business 1961-1992	<b>KNOWLTON, ROGER</b> Mathematics 1976-1999	<b>MARCUSON, BRUCE</b> Administration of Justice 1990-2012
<b>BILLINGS, ROBERT C.</b> Physical Ed, Auto Tech 1968-1999	<b>FARRIER, PAUL</b> History 1970-1994	<b>GUZMAN, CESAR</b> Counselor, Professor 1975-2011	<b>KOSKI, RAUHA K.</b> Nursing 1974-1981	<b>MARKS, BETTY</b> Nursing 1984-2000
<b>BORCHARD, MARY KAY</b> Professor, Administration of Justice P.O.S.T. Coordinator 1983-2006	<b>FIELDS, MAX</b> Health Education/Physical Education 1969-1994	<b>HANN, CAROL</b> Professor, English 1975-2006	<b>LANFORD, CONWAY</b> Counseling 1970-1984	<b>MARTINI, DONALD</b> English 2000-2014

† Deceased

<b>MCCORMICK, J. MICHAEL †</b> English 1972-2008	<b>PAINE, THOMAS</b> Computer Information Systems 1998-2011	<b>RODGERS, VALERIE</b> Business 1988-2011	<b>STEARNS, HAROLD †</b> Speech 1973-1986	<b>WASSON, HENRY †</b> Math/Science 1962-1994
<b>MCNEECE, BRIAN</b> English 1986-2015	<b>PAINE, YVONNE</b> English 2007-2011	<b>RUDOLPH, WILLIAM †</b> Dean of Vocational Education 1964-1993	<b>STONE, JAMES †</b> Mathematics/Music 1966-1986	<b>WEISSMAN, HARRY †</b> English 1969-1980
<b>MEEK, AL</b> Nursing 1974-2012	<b>PAULSON, CLARENCE †</b> Business 1960-1988	<b>SAMSON, WALTER †</b> History 1963-1982	<b>STROUD, VIVIAN</b> Nursing 1980-2011	<b>WELCH, T. LARRY</b> Librarian 1994-2004
<b>MELLINGER, ELWOOD †</b> Agriculture 1961-1989	<b>PENDLEY, J.R.</b> Science 1967-2003	<b>SAMUELS, CARMEN</b> Nursing 1971-1981	<b>STUART, BARBARA</b> English 1990-2007	<b>WENDRICK, MARY</b> English 1990-1999
<b>MOSIER, LAURA</b> Speech 2005-2015	<b>PERSKE, GERALD</b> Science 1960-1994	<b>SANTOS, RAFAEL †</b> Business 1975-1999	<b>SUCZEK, PETER</b> Psychology and Sociology 1974-2005	<b>WENDRICK, MEL †</b> Director of DSP&S 1973-1999
<b>MONTENEGRO, JEAN</b> English, ESL, and Exercise Science, Wellness & Sport 1966-2000	<b>PETERSON, AVIS</b> Nursing 1984-1991	<b>SANTISTEVAN, JUDY</b> Business, Work Experience 1999-2012	<b>SWANN, MARIE †</b> English 1964-1980	<b>WHITE, HOWARD †</b> Law Enforcement 1969-1979
<b>MOORE, ERNEST †</b> Business 1970-1978	<b>POLLOCK-BLEVINS, DIEDRE</b> Nursing 1985-2015	<b>SAXE, ELLEN</b> Nursing 1981-1990	<b>THOMPSON, BLAINE</b> Business 1962-1999	<b>WHITE, RAY</b> Automotive Technology 1964-1998
<b>MOORE, ROBERT</b> Business 1970-1988	<b>RAULSTON, JEAN †</b> English 1977-1994	<b>SECHRIST, WILLIAM †</b> VP/Bus Svcs/Deputy Supt 1990-1998	<b>THORNBURG, WILLIAM †</b> VP for Business Services 1967-1990	<b>WILHELM, ROBERT</b> Geography & Political Science 1970-2003
<b>NADEAU, NANCY</b> English Instructor 1975-2002	<b>RICE, PAULINE BENOIT †</b> Foreign Language/Humanities 1963-1988	<b>SEIVERTSON, BRUCE</b> Geography 2004-2012	<b>TOPPER, IRENE †</b> Nursing 1976-1984	<b>WILLIAMS, RICHARD †</b> Psychology 1974-1999
<b>NOVAK, RUTH †</b> Dean of Counseling 1958-1972	<b>RICHARDS-CROFT, DONNA</b> Business 1998-2005	<b>SMITH, MARY M. †</b> English 1975-1996	<b>UPSON, JOHN †</b> English 1966-1977	<b>WILSON, PATRICIA</b> English 1970-1991
<b>NILSON, BARBARA</b> Mathematics 1999-2014	<b>RICHWINE, HAROLD</b> Chemistry/Physical Ed 1960-1999	<b>SMITH, MELVIN †</b> Disabled Student Programs 1990-2003	<b>VALENTINE, BARBARA</b> Early Childhood Education 1978-1999	<b>ZOBELL, SHERRY</b> Math 1998-2009
<b>ORENSZTEIN, ARMAND</b> Math 1967-2009	<b>RIEHLE, BETSY</b> Mathematics 2002-2015	<b>SPEER, WILLIAM †</b> English 1961-1987	<b>VALENTINE, MARTIN</b> English 1976-2003	
<b>ORTEGA, ALICIA</b> Foreign Language 1967-2009	<b>RODDEN, ROSE †</b> Health Education 1974-1986	<b>SPENCER, TERREL †</b> Superintendent/President 1963-1978	<b>VON WERLHOF, JAY †</b> Anthropology/Social Science 1973-1991	
<b>OVERMAN, RUTH †</b> Business 1965-1981	<b>RODGERS, GARY</b> Anthropology/Sociology 1981-2010	<b>STANDIFORD, SANDRA</b> Counseling, Dean of Admissions 1967-2003	<b>WALKER, JAMES D.</b> VP/Academic Services/Deputy Superintendent 1969-1996	

† Deceased

# Imperial Valley College

## Campus Map

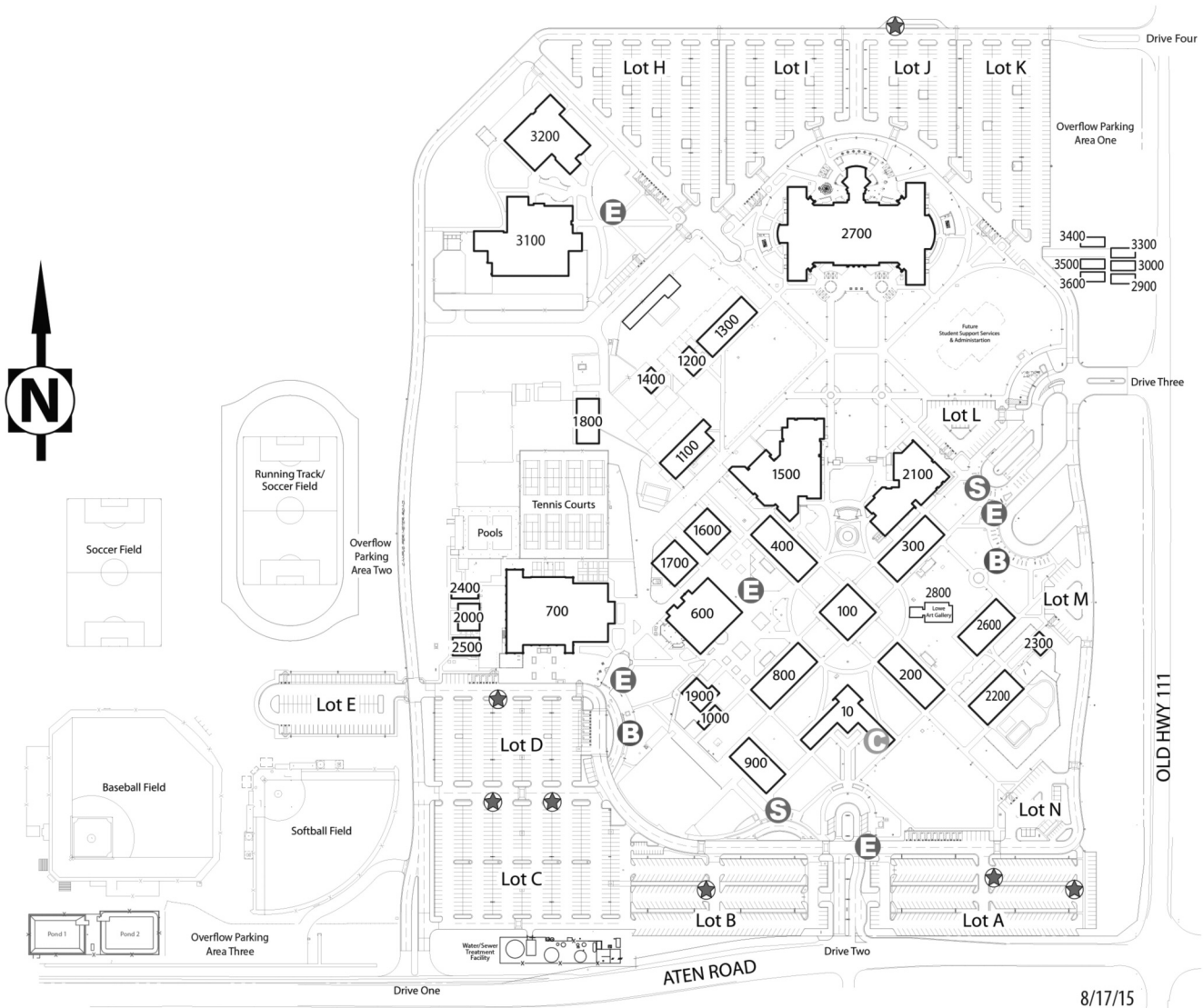

8/17/15

LEGEND			
10 Administration/Admissions & Records/IVC Foundation Office	300 Information Technology/Reprographics/Parking Control	1700 Financial Aid	2600 Reading/Writing/Language Lab
100 Counseling	1000 Student Affairs Office	1800 Maintenance/Purchasing/Warehouse	2700 English/Sciences/Math/Offices
200 Social Sciences/English	1100 Auto Tech	1900 Bookstore	2800 Juanita Salazar Lowe Art Gallery
300 Humanities/World Languages/Speech/Communications	1200 Welding	2000 Talent Search/Upward Bound	2900 Classroom - Temporary Building
400 Assessment Center/Classrooms	1300 Auto Tech/Humanities	2100 Health Sciences/Disabled Student Services	3000 Classroom - Temporary Building
600 College Center/Cafeteria	1400 Tool Storage	2200 Preschool	3100 Career Technical Education Building
700 Gymnasium	1500 Library Media Center/Student Health Center	2300 Infant Toddler Center	3200 Career Technical Education Building
800 Business/CIS	1600 Financial Aid Lab	2400 Human Resources	3300 Restroom Facility - Temporary Building
		2500 Math Lab Center	3400 Classroom - Temporary Building
Parking/Day Pass Machine	Student Drop Off	Bus/Transit Drop Off	3500 Classroom - ICOE
		Cashier/Student Payments	3600 Classroom - Temporary Building
		Emergency Call Box	



# Index

## A

Academic Calendar 6  
Academic Freedom Statement 32  
Academic Renewal 40  
Accreditation 2, 9  
Adding Classes 16  
Administration of Justice 61, 234  
Administration of Justice (For Transfer) 63  
Admission and Registration 11  
Agriculture 235  
Agricultural Business Management 65  
Agricultural Crop Science (Certificate Program) 66  
Agricultural Science 67  
Air Conditioning and Refrigeration 69, 237  
Alcohol and Drug Studies 71, 238  
Allied Health Professions 239  
Alternative Energy-Solar Technology 73  
American Indian Studies 239  
American Sign Language 240  
Anthropology (For Transfer) 75  
Anthropology 241  
Application 12  
Apprenticeship Courses of Instruction 225  
Apprenticeship Training Programs 47, 201  
Apprenticeship-Control Operator 203, 225  
Apprenticeship-Electrician 205, 225  
Apprenticeship-Generation Mechanic 207, 225  
Apprenticeship-Hydro Operator 209, 226  
Apprenticeship-Instrument Technician 211, 226  
Apprenticeship-Meter Technician 213, 227  
Apprenticeship-Power Lineman 215, 227  
Apprenticeship-Relays Technician 217, 227  
Apprenticeship-SCADA/Telecommunications Technician 219, 228  
Apprenticeship-Substation-Electrician 221, 228  
Apprenticeship-Telecommunications Technician 223, 229  
Arabic 241  
Art 241  
Assessment 17  
Associate Degrees 46, 48, 59  
Astronomy 243  
Athletics 28, 243  
Attendance and Administrative Withdrawals 40  
Automotive Technology 77, 245

## B

Behavioral Science 79  
Biology 247  
Board Of Trustees 5  
Bookstore and College Center 28  
Brakes, Suspension, and Steering 81

Building Construction 249  
Building Construction Technology 83  
Business Accounting Technician 87  
Business Administration 251  
Business Administration (For Transfer) 89  
Business Administrative Assistant 91  
Business Management 93  
Business Office Technician 95

## C

California State University General Education Breadth 52, 97  
CalWORKs Program (CalWORKs) 25  
Campus Map 322  
Campus Regulations 34  
Campus Safety 44  
Career Technical Education 47  
Centers for Students 30  
Certificates of Achievement Programs 46, 59  
Challenge Process 18  
Changes in the Catalog 34  
Cheating and Plagiarism 34  
Chemistry 253  
Child Development 99, 254  
Child Development Centers 28  
Child Development Administration Specialization 101  
Child Development Infant/Toddler Specialization 101  
Child Development School-Age Specialization 101  
Cisco CCNA Discovery 103  
Class Attendance 34  
College Policies, Rules and Regulations 31  
College Mission 9  
Communication Studies (For Transfer) 105  
Community Service Classes 28  
Computer Information Systems 107, 256  
Computer Science 109, 259  
Cooperative Agencies Resources for Education (CARE) 25  
Correctional Science 111, 259  
Counseling Services 23  
Counseling 260  
Courseload Limits 34  
Courses of Instruction 231  
Court Services Specialist 115  
Credit by Examination 36  
Credit for Advanced Placement Examinations (AP) 36  
Credit for College Level Examination Program (CLEP) 39  
Credit for Correspondence and Extension Courses 36  
Credit for Military Service 36  
Credit for Regional Occupational Program Courses 47  
Credit for Upper Division Course Work 36  
Credit from Foreign Institutions 40  
Cross Enrollment Program (CSU/UC) 58

## D

Degrees 10  
Dental Assistant 263  
Disabled Student Programs and Services (DSPS) 260  
Disclaimer 2  
Distance Education 27  
District Administration 316  
Dropping Classes 16

## E

Early Childhood Education (For Transfer) 113  
Economics 261  
Education 261  
Educational Master Plan 9  
Educational Talent Search 24  
Electrical/Electronic and Air Conditioning 115  
Electrical Technology 117  
Electrical Trades 121, 262  
Electrical Wiring 262  
Electronics 263  
Elementary Teacher Education (For Transfer) 123  
Eligibility 12  
Emergency Medical Services 125  
Emergency Medical Technician 263  
Emergency Medical Technician - Paramedic 263  
Emeritus Faculty 320  
Energy Efficiency Technology 127  
Engine Performance and Drivability 129  
Engine Repair and Machinist 131  
Engineering 265  
English 265  
English (For Transfer) 133  
English as a Second Language 267  
Enrollment Fees 19  
Environmental Science 270  
Extended Opportunity Program and Services (EOPS) 25

## F

Faculty 316  
Family Educational Rights and Privacy (FERPA) 32  
Fees and Refunds 19  
Financial Aid 22  
Film Studies 270  
Fire Science 270  
Fire Technology 135  
Firefighter I 139  
Foreign Transcripts 40  
Formal Resolution 42  
French 141, 275

## G

General Science 143  
Geography 275  
Geology 275  
Grading System 35  
Graduation Requirements 49

## H

Health Education 276  
History 276  
History (For Transfer) 145  
History of the College 7  
Human Relations 149  
Humanities 149, 278

## I

Informal Resolution 42  
Institutional Student Learning Outcomes 10  
Intersegmental General Education  
Transfer Curriculum (IGETC) 55, 151

## J

Journalism 278

## K

Kinesiology (For Transfer) 153

## L

Latina/Latino Studies 278  
Learning and Tutoring Services Centers 30  
Legal Assistant 153, 279  
Liberal Studies-General Option 155  
Liberal Studies-SDSU Teacher Preparation Option 157  
Life Science 155

## M

Majors 48, 59  
Mathematics 157, 280  
Mathematics (For Transfer) 159  
Mathematics Prerequisite Chart 308  
Medical Assistant 161, 282  
Multimedia and Web Development 163  
Music 283  
Music (For Transfer) 165

## **N**

Nondiscrimination and Sexual Harassment Policy 32  
Non-Credit Education 28  
Nursing Appendix 309  
Nursing-Associate Degree (R.N.) 167, 286  
Nursing-Vocational (V.N.) 169, 290

## **O**

Online Services and Distance Education 27  
Open Enrollment 34  
Other Fees/Charges 20

## **P**

Parking 44  
Parking Fee 20  
Petition And Hearing Process 43  
Philosophy 292  
Pharmacy Technician 171, 292  
Physical Education 173, 293  
Physical Science 175, 296  
Physics 296  
Policy for Earnibg College Credit 36  
Political Science 296  
Political Science (For Transfer) 177  
Pre-Engineering 179  
Prerequisite, Corequisite, Advisories On  
Recommended Preparation and Limitations  
On Enrollment 18, 232  
President's Message 4  
Probation, Dismissal, Reinstatement 41  
Proficiency Enrollment 34  
Psychology 297  
Psychology (For Transfer) 181

## **R**

Reading 298  
Refund Policy 20  
Registration 14  
Regulations 31  
Religious Studies 299  
Renewable Energy 299  
Repeating Courses 17  
Residency 12

## **S**

Scholarships 23  
Scholastic Honors 35

Social Science 183  
Social Work 300  
Sociology 300  
Sociology (For Transfer) 185  
Spanish 301  
Spanish (For Transfer) 187  
Speech 302  
Spencer Library and Media Center 29  
Strategic Plan 9  
Student Activities 28, 41  
Student Conduct 41  
Student Complaint Policy 42  
Student Email 27  
Student Health Services 28  
Student Success and Support Program 17  
Student Support Services and Special Programs 21  
Studio Arts (For Transfer) 189  
Summer Session 233

## **T**

Table of Contents 3  
Theatre Arts 303  
Transcript Fee 20  
Transfer Center 24  
Transfer Credit 36  
Transfer Planning 51  
Transfer Preparation 51  
Transmission and Power Train 191  
Types of Courses and Programs 9

## **U**

University Studies 193  
Upward Bound 24

## **V**

Veterans Services 26  
Voluntary Withdrawal 41

## **W**

Wait Lists 15  
Water Treatment Systems Technology 197, 303  
Welding 304  
Welding Technology 199  
Western Undergraduate Exchange (WUE) 51  
Work Experience 29, 305

